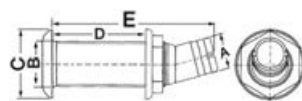

Scarico a mare

Con battuta frontale a vista in acciaio inox lucidata a specchio, inclinati di 15°.

Codice	Ø A mm	Filetto B mm	Ø B mm	Ø C mm	D mm	E mm	Valvola di non ritorno
17.331.06	38	2" 1/4	57	76	94	170	Si
17.331.07	50	2" 1/4	57	76	94	170	Si
17.329.06	38	2" 1/4	57	76	94	170	-
17.329.07	50	2" 1/4	57	76	94	170	-

**Valvola a sfera femmina/femmina**

In polipropilene, con sfera interna in nylon, leggere, robuste e sicure.

Codice	Filetto	Codice	Filetto
17.233.02	1/2"	17.233.05	1" 1/4
17.233.03	3/4"	17.233.06	1" 1/2
17.233.04	1"		

**Portagomma polipropilene attacco a girello e guarnizione**

Codice	Versione	Filetto	Ø portagomma mm
17.235.00	A 90°	1/2"	12
17.235.01	A 90°	3/4"	16
17.235.02	A 90°	3/4"	19
17.235.03	A 90°	1"	25
17.235.04	A 90°	1" 1/4	30
17.235.05	A 90°	1" 1/2	38
17.235.99	Dritto	3/8"	12
17.236.00	Dritto	1/2"	13
17.236.01	Dritto	1/2"	16
17.236.21	Dritto	3/4"	16
17.236.02	Dritto	3/4"	19
17.236.22	Dritto	1"	20
17.236.03	Dritto	1"	25
17.236.04	Dritto	1" 1/4	30
17.236.23	Dritto	1" 1/4	32
17.236.05	Dritto	1" 1/2	38

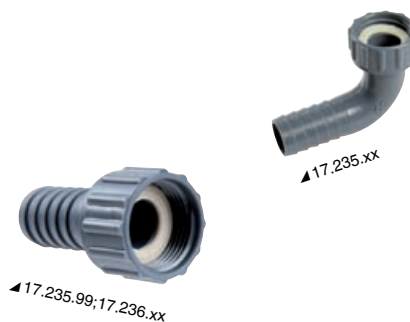
**Portagomma maschio a 90° in polipropilene**

Codice	Filetto	Ø portagomma mm
17.238.01	3/8"	12
17.238.02	1/2"	16
17.238.03	3/4"	20
17.238.04	3/4"	25
17.238.05	1"	25
17.238.06	1"	30
17.238.07	1" 1/4	32
17.238.08	1" 1/2	38

**Portagomma maschi in policarbonato nero**

Codice	Filetto	Ø portagomma mm	ORDER BY BOX
17.206.40	1/2"	18	10
17.206.41	3/4"	23	10
17.206.42	1"	30	10
17.206.43	1" 1/4	38	10
17.206.44	1" 1/2	46	10

**Portagomma maschio in polipropilene**

Codice	Filetto	Ø portagomma mm	ORDER BY BOX	Codice	Filetto	Ø portagomma mm	ORDER BY BOX
17.234.00	3/8"	12	20	17.234.23	1"	20	10
17.234.01	3/8"	16	20	17.234.06	1"	25	10
17.234.21	1/2"	13	20	17.234.07	1"	30	10
17.234.02	1/2"	16	20	17.234.08	1" 1/4	30	10
17.234.03	1/2"	20	20	17.234.09	1" 1/4	35	10
17.234.22	3/4"	16	20	17.234.24	1" 1/4	38	10
17.234.04	3/4"	20	20	17.234.10	1" 1/2	38	5
17.234.05	3/4"	25	20	17.234.11	1" 1/2	50	5

