

Raccorderia, scarichi a mare e valvole in ottone

Scarico a mare con testa bombata, tutto filetto

| Filetto | Ottone cromato | Ottone giallo | L mm | Ø D mm | Ø G mm |
|---------|----------------|---------------|------|--------|--------|
| 3/8" | 17.321.60 | 17.321.80 | 55 | 35 | 17 |
| 1/2" | 17.321.61 | 17.321.81 | 65 | 40 | 21 |
| 3/4" | 17.321.62 | 17.321.82 | 70 | 48 | 26 |
| 1" | 17.321.63 | 17.321.83 | 75 | 55 | 33 |
| 1" 1/4 | 17.321.64 | 17.321.84 | 85 | 65 | 42 |
| 1" 1/2 | 17.321.65 | 17.321.85 | 85 | 70 | 48 |
| 2" | 17.321.66 | 17.321.86 | 100 | 83 | 60 |
| 2" 1/2 | 17.321.67 | 17.321.87 | 130 | 110 | 75 |
| 3" | 17.321.68 | 17.321.88 | 155 | 121 | 88 |
| 4" | 17.321.69 | 17.321.89 | 210 | 150 | 113 |

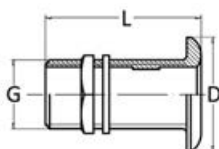

OSCOLATI

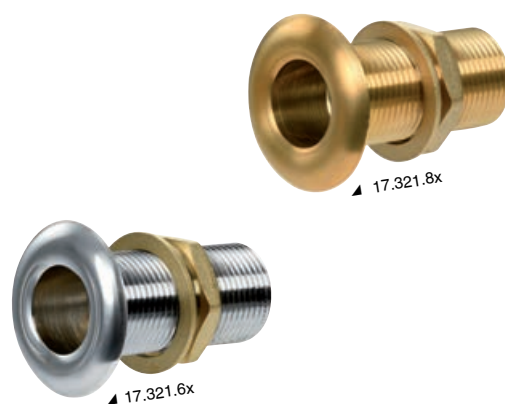

Scarico a mare con testa piatta, tutto filetto

| Filetto | Ottone cromato | Ottone giallo | L mm | Ø D mm | Ø G mm | S mm |
|---------|----------------|---------------|------|--------|--------|------|
| 3/8" | 17.324.10 | 17.324.00 | 55 | 35 | 17 | 5 |
| 1/2" | 17.324.11 | 17.324.01 | 65 | 40 | 21 | 5 |
| 3/4" | 17.324.12 | 17.324.02 | 70 | 48 | 26 | 5 |
| 1" | 17.324.13 | 17.324.03 | 75 | 55 | 33 | 5 |
| 1" 1/4 | 17.324.14 | 17.324.04 | 85 | 65 | 42 | 6 |
| 1" 1/2 | 17.324.15 | 17.324.05 | 85 | 70 | 48 | 5 |
| 2" | 17.324.16 | 17.324.06 | 100 | 83 | 60 | 8 |

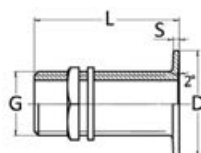

OSCOLATI



Scarico a mare con testa inclinata, tutto filetto

| Filetto | Ottone cromato | Ottone giallo | L mm | Ø D mm | Ø G mm |
|---------|----------------|---------------|------|--------|--------|
| 3/8" | 17.324.40 | 17.324.30 | 55 | 35 | 17 |
| 1/2" | 17.324.41 | 17.324.31 | 65 | 40 | 21 |
| 3/4" | 17.324.42 | 17.324.32 | 70 | 48 | 26 |
| 1" | 17.324.43 | 17.324.33 | 75 | 55 | 33 |
| 1" 1/4 | 17.324.44 | 17.324.34 | 85 | 65 | 42 |
| 1" 1/2 | 17.324.45 | 17.324.35 | 85 | 70 | 48 |
| 2" | 17.324.46 | 17.324.36 | 100 | 83 | 60 |

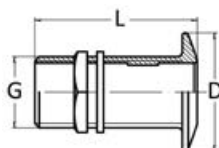

OSCOLATI



Scarico a mare con testa bombata, con portagomma

| Filetto | Ottone cromato | Ottone giallo | L mm | L1 mm | Ø D mm | Ø G mm |
|-------------|----------------|---------------|------|-------|--------|--------|
| 3/8" x 15 | 17.423.00 | 17.323.00 | 55 | 20 | 35 | 17 |
| 1/2" x 19 | 17.423.01 | 17.323.01 | 65 | 25 | 40 | 21 |
| 3/4" x 25 | 17.423.02 | 17.323.02 | 65 | 30 | 48 | 26 |
| 1" x 30 | 17.423.03 | 17.323.03 | 70 | 31 | 55 | 33 |
| 1" 1/4 x 38 | 17.423.04 | 17.323.04 | 80 | 31 | 65 | 42 |
| 1" 1/2 x 45 | 17.423.05 | 17.323.05 | 80 | 31 | 70 | 48 |
| 2" x 55 | 17.423.06 | 17.323.06 | 92 | 31 | 83 | 60 |

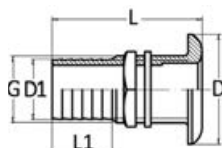

OSCOLATI

