

Anodo 6/8/9,5/15 HP

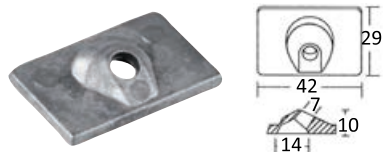

Codice	Riferimento originale
43.433.01	42121

Piastra entro-fuoribordo per Alpha One



Zinco	Alluminio	Magnesio	Riferimento originale
43.435.10	43.435.11	43.435.12	815933A1/ 821629A1

Anodo per barra motori



Per barra motori 2 e 4 tempi da 30 a 200 HP e Superamerica, con 4 fori.

Zinco	Alluminio	Magnesio	Riferimento originale
43.434.10	43.434.11	43.434.12	818298A1

Placca per Bravo

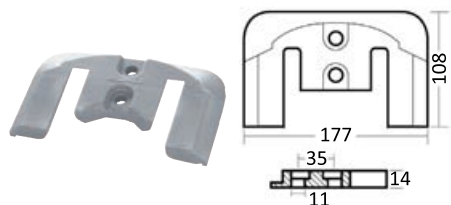

Zinco	Alluminio	Magnesio	Riferimento originale
43.435.20	43.435.21	43.435.22	821630A/C

Anodo gruppi poppieri per Mercruiser

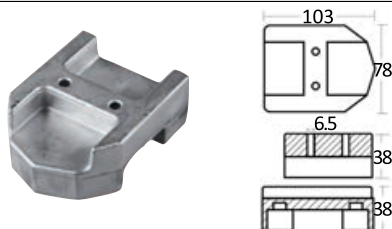

Zinco	Alluminio	Magnesio	Riferimento originale
43.435.00	43.435.01	43.435.02	821631A-1

Anodo fuoribordo 2/6 HP

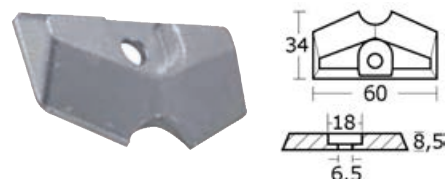

Codice	Riferimento originale
43.259.03	810945M

Collare per Alpha

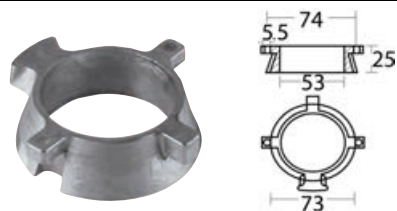

Zinco	Alluminio	Magnesio	Riferimento originale
43.432.00	43.432.10	43.432.11	806105A

Anodo piede per Bravo/Blackhawk

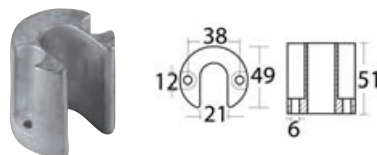

Zinco	Alluminio	Magnesio	Riferimento originale
43.424.00	43.424.30	43.424.31	806190A

Anodo piede per Mercruiser/Alpha

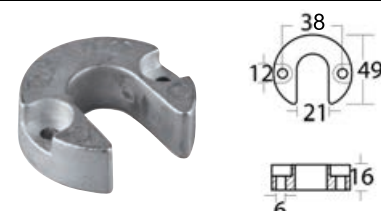

Zinco	Alluminio	Magnesio	Riferimento originale
43.424.01	43.424.22	43.424.23	806189A

Anodo per Mercury da 30/300 HP 2 e 4 tempi

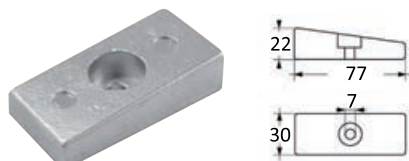

Zinco	Alluminio	Magnesio	Riferimento originale
43.424.05	43.424.08	43.424.09	826134

Piastra 25/40 HP

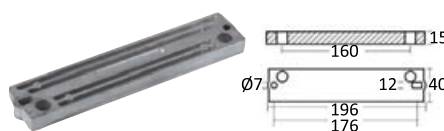

Zinco	Alluminio	Magnesio	Riferimento originale
43.640.04	43.640.14	43.640.17	8239121

Barra per Verado



Zinco	Alluminio	Riferimento originale
43.424.20	43.424.21	8M00-12083

Rondella

Zinco	Alluminio	Magnesio	Ø mm	Rif. originale
43.823.91	43.823.92	43.823.93	20x7	823912
43.239.13	43.239.14	43.239.15	24x6,5	823913
-	43.640.16	-	24x7	823912
43.824.91	43.824.92	43.824.93	20x7	823912-1

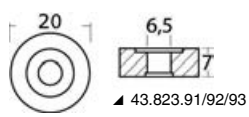

▲ 43.823.91/92/93

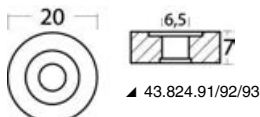

▲ 43.824.91/92/93

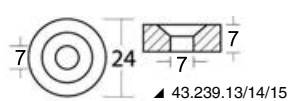

▲ 43.239.13/14/15

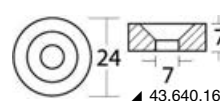

▲ 43.640.16

Anodo supporto base poppieri

Zinco	Alluminio	Magnesio	Descrizione	A mm	B mm
43.442.00	-	-	Anodo supporto base gruppi poppieri filetto 12x1,75 mm	22/25	35
43.442.01	43.442.11	43.442.12	Anodo supporto base gruppi poppieri (rif. orig. 55989A) filetto 1/2" UNC (120/160 HP) (rif. orig. 55989A3) piedi ALPHA / BRAVO	33	29

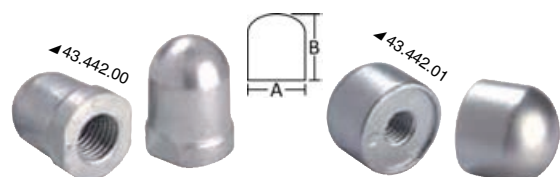

▲ 43.442.00

▲ 43.442.01